

Zooma Half-Marathon

Colorado Springs, CO
 USATF Certificate CO11026DCR
 Effective 6/13/2011 - 12/31/2021

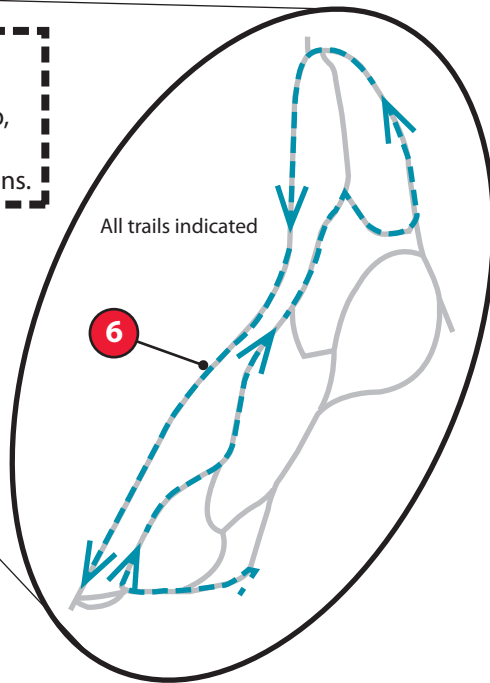

GPS coordinates are given ONLY to get close to described locations. NOT to be used to replace lost marks. Use descriptions to replace lost marks. NAD83

- Start: N38.83323 W104.82604
- 1 mile: N38.82184 W104.82431
- 2 mile: N38.83524 W104.82213
- 3 mile: N38.84235 W104.81213
- 4 mile: N38.85372 W104.81775
- 5 mile: N38.85904 W104.82956
- 6 mile: N38.86266 W104.82912
- 7 mile: N38.84923 W104.82849
- 8 mile: N38.83603 W104.82971
- 9 mile: N38.82370 W104.83518
- 10 mile: N38.81441 W104.82471
- 11 mile: N38.80126 W104.82631
- 12 mile: N38.79118 W104.83357
- 13 mile: N38.78414 W104.82273
- Finish: N38.78368 W104.82468

Course measured following shortest possible route on trail, but stayed within 5' of curb on all roads except Cascade.
 Course is to-scale, but trail and street widths are not.
 Not all cross-trails or cross-streets are shown.

- Start: 12' E of curb corner. Also, 10' W of 3rd light post from Cascade, N side of driveway
- 1 mile: 2' E of storm sewer manhole cover at corner of Tejon & Fountain
- 2 mile: 4' E of west pillar at exit for bus station
- 3 mile: 57' N of N edge of east-west sidewalk, north side of road
- 4 mile: 24' E of sidewalk at house west of 324 Columbia (no visible number on house with sidewalk)
- 5 mile: On Culebra Ave, 42' E of LP 002436 (N side of road), W of Culebra Pl intersection
- 6 mile: 122' NE of BIG cottonwood at curve in trail
- 7 mile: 36' S of S end of dugout wall at baseball field
- 8 mile: 9' W of trail concrete (not bridge concrete) on W side of creek
- 9 mile: 66' N of "T" intersection sign, N of bridge across creek
- 10 mile: 62' S of light island at exit from I-25
- 11 mile: Center of middle entrance to church on N side of road
- 12 mile: 40' W of "Speed Limit 35" sign, in front of 220 Ch. Mtn. Blvd
- 13 mile: 54' downhill from hydrant #95, on N side of road
- Finish: At green utility post (6"x 6"x 18") 35 yards west of gates

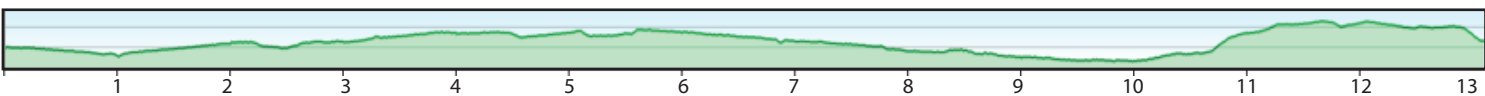
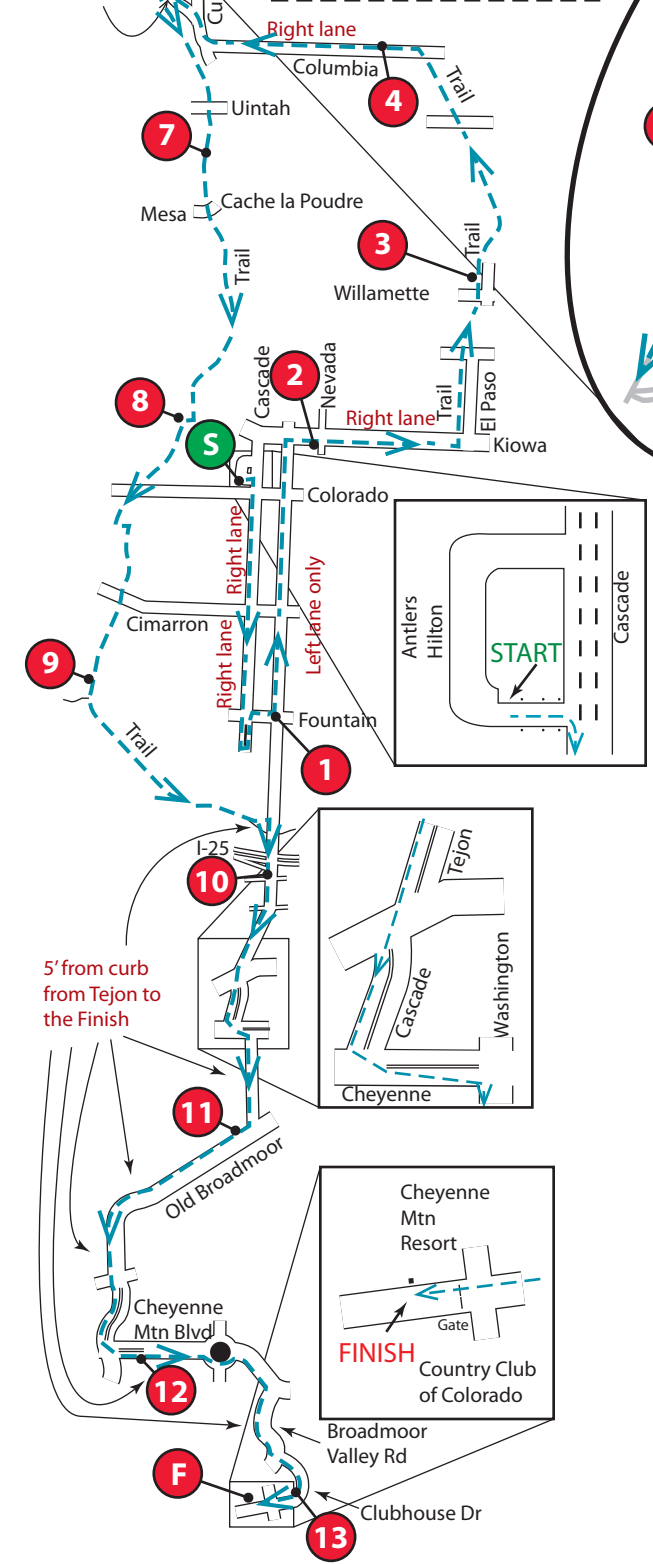

Start elevation: 5999' Finish elevation: 6032' High point: 6128' Low point: 5932'
 Measurement, map, and elevation profile by RaceMeasure, June, 2011. www.RaceMeasure.com